



BS EN ISO 9001:2008 Cert No. 7878
Shower and bathroom equipment

Orders & quotes

01905 823299

orders@akw-ltd.co.uk

General enquiries

01905 823298

sales@akw-ltd.co.uk

Technical enquiries

01905 560219

technicalenquiries@akw-ltd.co.uk

Kitchen enquiries

01905 823262

kitchens@akw-ltd.co.uk

Fax

01905 823297

AKW

Pointon Way
Hampton Lovett
Droitwich Spa
WR9 0LR

Website

www.akw-ltd.co.uk



Livenza®

Standard Height Contract Sanitaryware

AKW, market leading contract suppliers for over 25 years

AKW
life. style. choice.

lifestyle
solutions for
inclusive living



UK mainland only. Layout and content ©2013 AKW Medi-Care Limited.
Artwork by Beard Creative Ltd. Printed in England.

AKW01572. Nov 2013 Rev 2.

AKW
life. style. choice.

lifestyle
solutions for
inclusive living



Livenza®

A new sanitaryware range offering flexibility and choice at highly competitive prices.

With over 25 years' of experience in supplying to installers our new sanitaryware has been carefully selected with quality and functionality in mind. Livenza® is a flexible range that not only offers a variety of options but is also quick and easy to fit.

- Durable, functional sanitaryware
- Tested and approved for use on contract specification
- BS EN 997 and BS EN 14688 compliant
- WRAS approved flush mechanism
- Excellent stockholding for guaranteed availability
- Expert technical support and after-sales service
- All spares stocked and readily available



General: 01905 823298 Order line: 01905 823299 Email: sales@akw-ltd.co.uk

AKW
life. style. choice.

lifestyle
solutions for
inclusive living

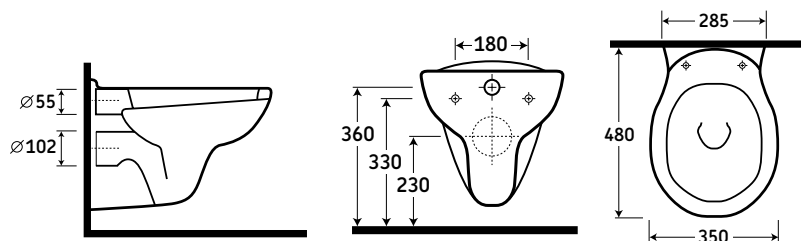

Note: Measurements shown are in millimetres (mm).



Wall Hung Pan and Seat

- Rounded edges and corners for safety
- Standard 102mm diameter outlet for easy plumbing
- Complies with BS EN 997 ensuring flush performance
- Matching wrap over seat available
- Compatible with standard wall hung frames
- Market leading Geberit Wall Hung Frame available from AKW
- Lifetime guarantee against manufacturer's defects in ceramics
- 10 year guarantee on flush fitting

Product	Codes
Wall hung WC pan	23518
Seat for wall hung pan	23519

Geberit Duofix Frame and Cistern

- Wall hung frame and integrated concealed cistern for installation of the Livenza® wall hung pan
- Can be used in front of solid or drywall construction
- Self-supporting frame with C profile 40/40mm
- Geberit Sigma concealed cistern for tool free mounting and fully insulated against condensation
- Frame height adjustable from 820-1020mm
- Flush valve allows for 3/6 litre flush or 3/4.5 litre flush

Product	Codes
Geberit Duofix wall hung frame and cistern	23515
Geberit flush plate chrome	23516
Geberit flush plate white	23517

WRAS approval number: 1309076

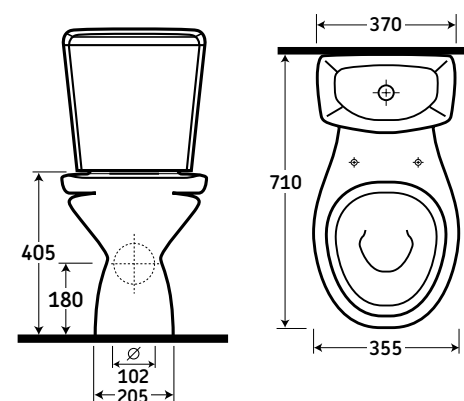
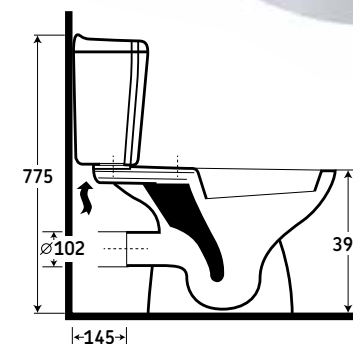

Note: Measurements shown are in millimetres (mm).

Close-Coupled Pan, Cistern and Seat

- Rounded edges and corners for safety
- 3/6 litre flush for water efficiency
- Chrome push button dual flush
- Bottom inlet tank
- Exposed outlet for easy fitting and maintenance
- WRAS approved flush fittings included, WRAS approval number: 0904330
- Complies with BS EN 997 ensuring flush performance
- Matching wrap over seat available
- Lifetime guarantee against manufacturer's defects in ceramics
- 10 year guarantee on flush fittings

Product	Codes
Standard close-coupled pan	23501
Cistern tank for close-coupled pan**	23502
Seat for close-coupled pan	23505

**Flush fittings included



* Exclusions apply.

450mm Basin with single tap hole



550mm Basin with single tap hole



Basins

- Rounded edges and corners for safety
- Single & double tap holes available on all sizes
- Chrome overflow insert
- Flat tap deck for easy cleaning
- No chain-stay to allow use of clicker waste
- Matching full or semi pedestal available
- Lifetime guarantee against manufacturer’s defects
- Waste, trap, tap and pedestal supplied separately

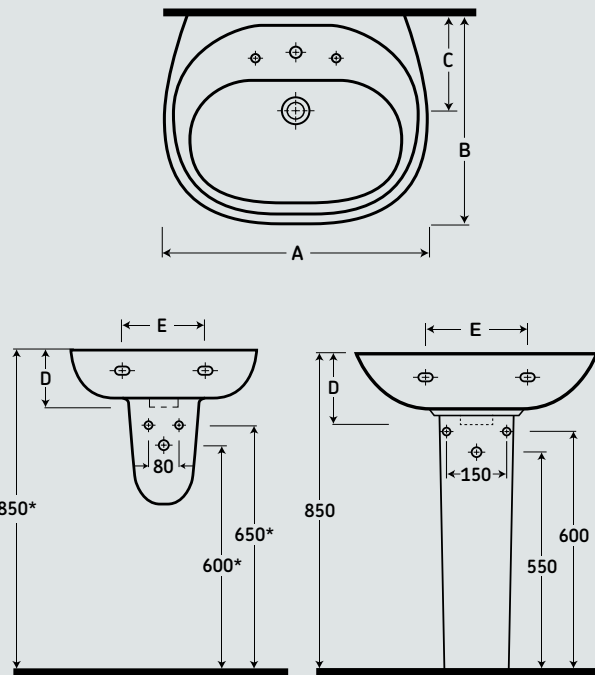

Note: Measurements shown are in millimetres (mm).
* These dimensions are based on a typical installation and can be adjusted.

Product	Code	Dimension (mm)				
		A	B	C	D	E
		Width	Depth	Dist to Waste	Height	Fixing Holes
450mm basin 1 tap hole	23507	450	365	165	140	220
450mm basin 2 tap hole	23512	450	365	165	140	220
500mm basin 1 tap hole	23503	500	395	185	155	280
500mm basin 2 tap hole	23513	500	395	185	155	280
550mm basin 1 tap hole	23508	550	430	205	170	280
550mm basin 2 tap hole	23514	550	430	205	170	280

Shown above: AKW Denova® Monobloc Mixer Tap



Pedestals

- Perfect match to all AKW Livenza® Basins
- Small semi pedestal for 450mm and 500mm basins
- Large semi pedestal for 550mm basins
- Easy to use fixings supplied with semi pedestal
- Lifetime guarantee against manufacturer’s defects

Product	Codes
Small semi pedestal	23504
Large semi pedestal	23511
Full pedestal	23510

Taps

- Easy to use handles
- Water saving with flow limiter included
- Easy to install flexitail fitting
- Clicker waste included with all basin mixers
- Suitable for all systems
- Lifetime guarantee on all non-perishable items

Product	Product Codes	WRAS Approval Number
AKW Denova® basin mono mixer tap	23316	1012378
AKW Denova® mini basin mono mixer tap	23317	1109438
AKW Denova® basin taps	23315	1009405



* Exclusions apply.



AKW®
life. style. choice.

lifestyle
solutions for
inclusive living